

- 外圈有一道軸向縫。
Outer ring with single split in axial direction.
- ES型內、外圈有潤滑油槽、油孔。
Lubrication grooves and holes in the outer and inner rings of type.
- Es...2RS型兩面帶密封圈。
Outer ring of type ES...2RS with two seals.
- 零件邊面磷化處理。
Both outer and inner rings are properly phosphorlylate-treated.

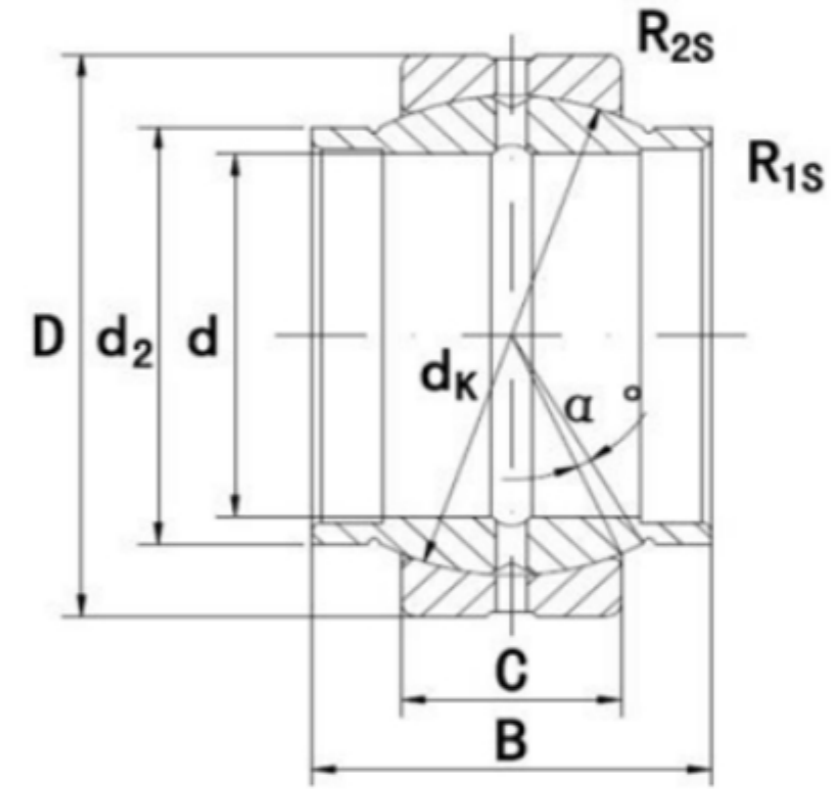

軸承型號 Bearing Number	主要尺寸 Dimensions (mm)									額定載荷 Load Ratings (kN)		重量 Weight (kg)
	d	d2	D	B	C	dk	R1s min	R2s min	$\alpha \approx$	動載荷 Dynamic	靜載荷 Static	
GE-12LO	12	15.5	22	12	7	18	0.3	0.3	4	10	53	0.017
GE-16LO	16	20	28	16	9	23	0.3	0.3	4	17	85	0.034
GE-20LO	20	25	35	20	12	29	0.3	0.3	4	30	146	0.069
GE-25LO	25	30.5	42	25	16	35.5	0.6	0.6	4	48	240	0.124
GE-30LO	30	34	47	30	18	40	0.6	0.6	4	62	310	0.159
GE-32LO	32	38	52	32	18	44	0.6	1	4	65	328	0.207
GE-35LO	35	40	55	35	20	48	0.6	1	4	79	399	0.248
GE-40LO	40	46	62	40	22	53	0.6	1	4	99	495	0.349
GE-50LO	50	57	75	50	28	66	0.6	1	4	156	780	0.62
GE-60LO	60	68	90	60	36	80	1	1	4	245	1220	1.11
GE-63LO	63	71.5	95	63	36	83	1	1	4	253	1260	1.27
GE-70LO	70	78	105	70	40	92	1	1	4	313	1560	1.69
GE-80LO	80	91	120	80	45	105	1	1	4	400	2000	2.55
GE-90LO	90	99	130	90	50	115	1	1	4	488	2440	3.04
GE-100LO	100	113	150	100	55	130	1	1	4	607	3030	4.87
GE-110LO	110	124	160	110	55	140	1	1	4	654	3270	5.53
GE-125LO	125	138	180	125	70	160	1	1	4	950	4750	8.19
GE-160LO	160	177	230	160	80	200	1	1	4	1360	6800	15.8
GE-200LO	200	221	290	200	100	250	1.1	1.1	4	2120	10600	31.7